

## WeatherBond™ Pro ROOFING SYSTEM

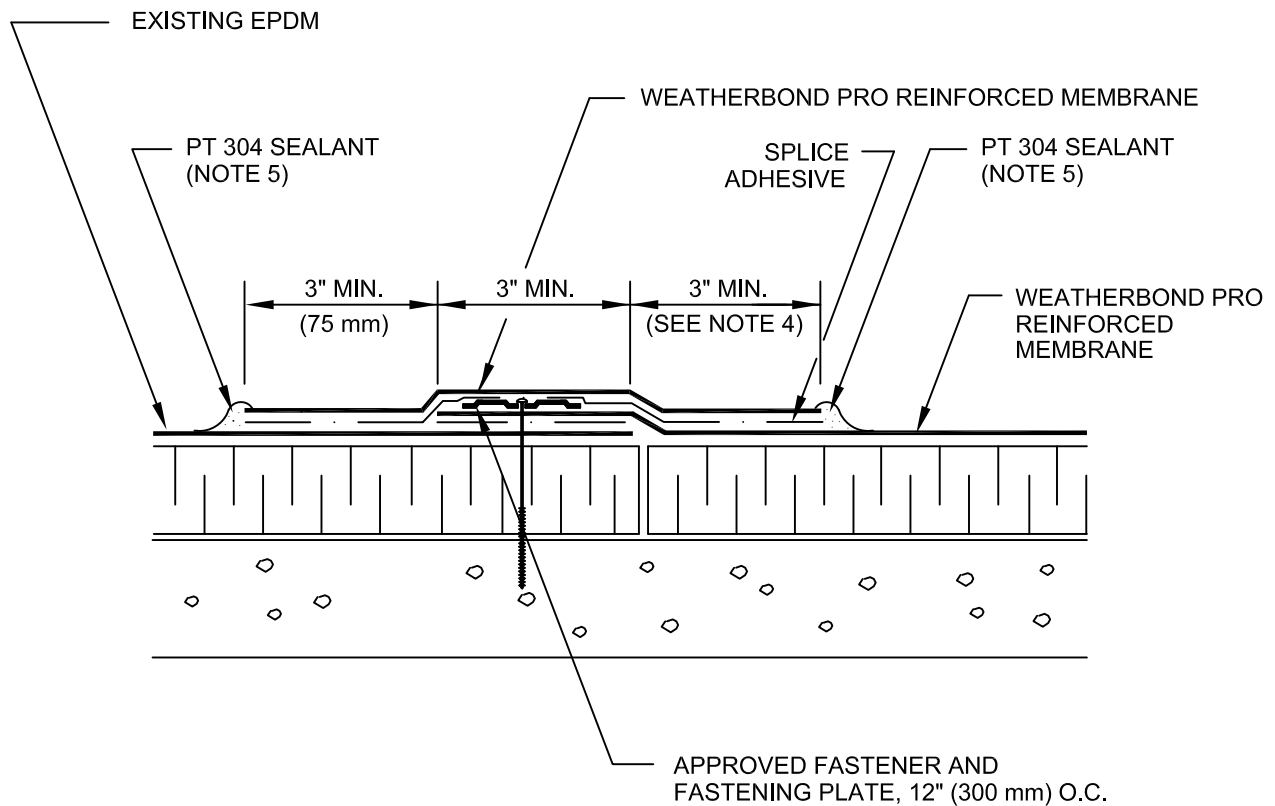

### NOTES:

1. REFER TO SPECIFICATION FOR ACCEPTABLE FASTENERS AND PLATES.
2. REFER TO WEATHERBOND'S EPDM INSTALLATION PROCEDURE FOR SURFACE PREPARATION REQUIREMENTS FOR EXISTING MEMBRANE.
3. PRIOR TO SEAM ADHESIVE APPLICATION, USE WEATHERED MEMBRANE CLEANER TO PREPARE SURFACES OF WEATHERBOND PRO AND CLEANED EPDM MEMBRANE.
4. A MINIMUM 1-1/2" (40 mm) HOT AIR WELD MAY BE PROVIDED IN LIEU OF SEAM ADHESIVE (USE CUT-EDGE SEALANT IN LIEU OF PT 304 SEALANT).
5. WEATHERBOND MULTIPURPOSE PRIMER MUST BE USED TO PREPARE MEMBRANE SURFACES PRIOR TO APPLYING PT 304 SEALANT.

WBPC-13.3  
TIE-IN EXISTING EPDM

**WEATHERBOND™**  
© 2007 WEATHERBOND