

OPTION 1

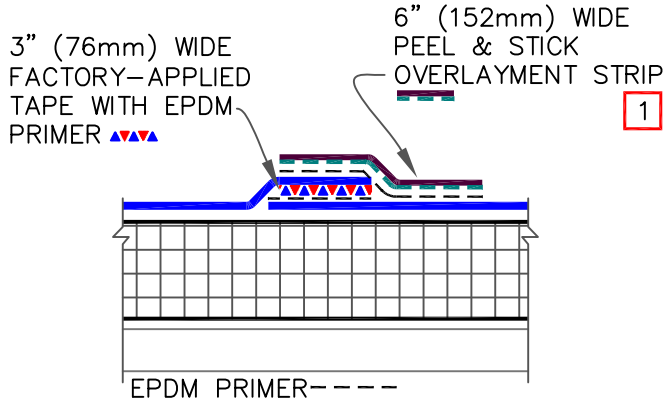

OPTION 2

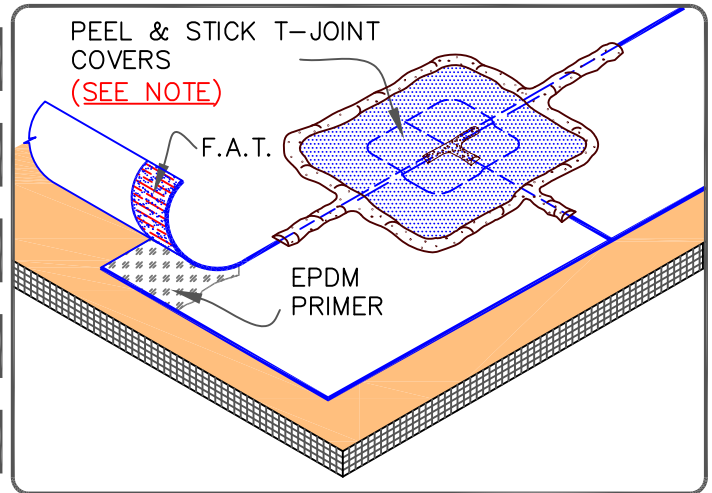
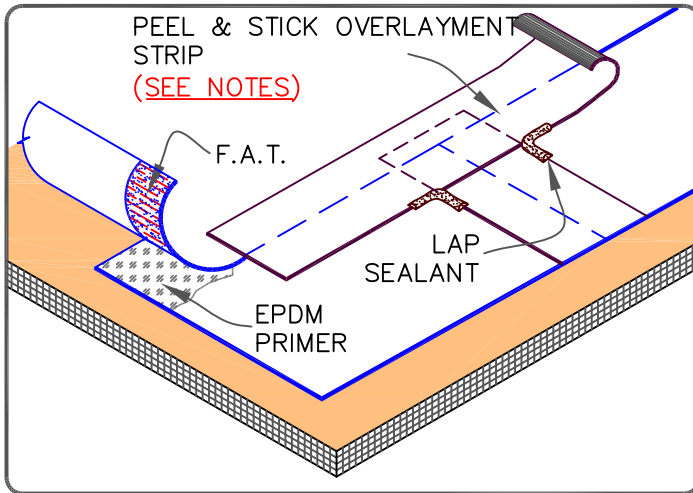
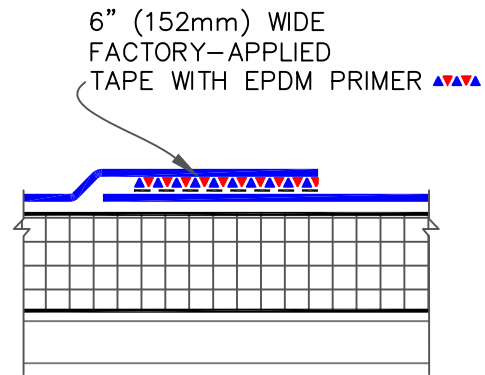

F.A.T. (FACTORY APPLIED SecurTAPE)

NOTES:

1. PROJECTS WITH 90-MIL EPDM MEMBRANE, TAPE SPLICES MAY BE A MINIMUM 3" (76mm) WIDE FACTORY APPLIED TAPE (F.A.T). IN ADDITION, OVERLAY THE ENTIRE FIELD SPLICE WITH A CONTINUOUS 6" (152mm) WIDE PEEL & STICK OVERLAYMENT STRIP.
2. APPLY LAP SEALANT AT ALL INTERSECTIONS BETWEEN PEEL & STICK OVERLAYMENT STRIP.

NOTE:

PROJECTS WITH 90-MIL EPDM MEMBRANE, TAPE SPLICES MUST BE A MINIMUM 6" (152mm) WIDE FACTORY APPLIED SecurTAPE (F.A.T). ALL SPLICE INTERSECTIONS MUST BE OVERLAID WITH TWO LAYERS OF PEEL & STICK ELASTOFORM FLASHING. APPLY LAP SEALANT ALONG THE LEADING EDGE OF THE MEMBRANE SPLICE COVERING 1/2" (13mm) IN ALL DIRECTIONS FROM THE SPLICE INTERSECTION AND OVERLAY WITH A 6"X6" (152mm X 152mm) T-JOINT COVER A SECOND LAYER OF 12"X12" (305mm X 305mm) PEEL & STICK T-JOINT COVER IS REQUIRED. BOTH LAYERS SHALL BE CENTERED OVER THE SPLICE INTERSECTION AND SEALED WITH CONTINUOUS LAP SEALANT.