

NOTES:

1. WHEN WEATHERBOND EXPANSION JOINT SUPPORT IS USED, WIDTH OF JOINT SHALL BE A MINIMUM OF 3/4" (19mm) AND SHALL NOT EXCEED 2" (51mm).
2. APPROXIMATELY 1/8" (3MM) DIAMETER BEAD OF CUT-EDGE SEALANT IS REQUIRED ON CUT EDGES OF WEATHERBOND REINFORCED TPO MEMBRANE AND RECOMMENDED ON CUT EDGES OF WEATHERBOND PVC MEMBRANE.
3. MEMBRANE FLASHING SHALL NOT BE ADHERED OVER THE EXPANSION JOINT SUPPORT OR SPONGE TUBING.
4. ON MECHANICALLY ATTACHED SYSTEMS, HPWX FASTENERS AND PLATES ARE REQUIRED OVER STEEL AND WOOD DECKS. ON CONCRETE DECKS, APPROVED CONCRETE FASTENERS ARE USED WITH HPWX PLATES.

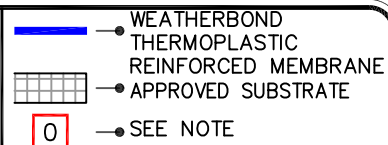

DECK-TO-WALL
EXPANSION DETAIL



THERMOPLASTIC
ROOFING SYSTEM
WBPC-3.2