

DIMENSIONS		mm	
(A)	6"	152	MAX.
(B)	1-1/2"	38	MIN.
(C)	1/2"	13	MIN.
(D)	1"	25	MIN.
(E)	12"	305	APPROX.

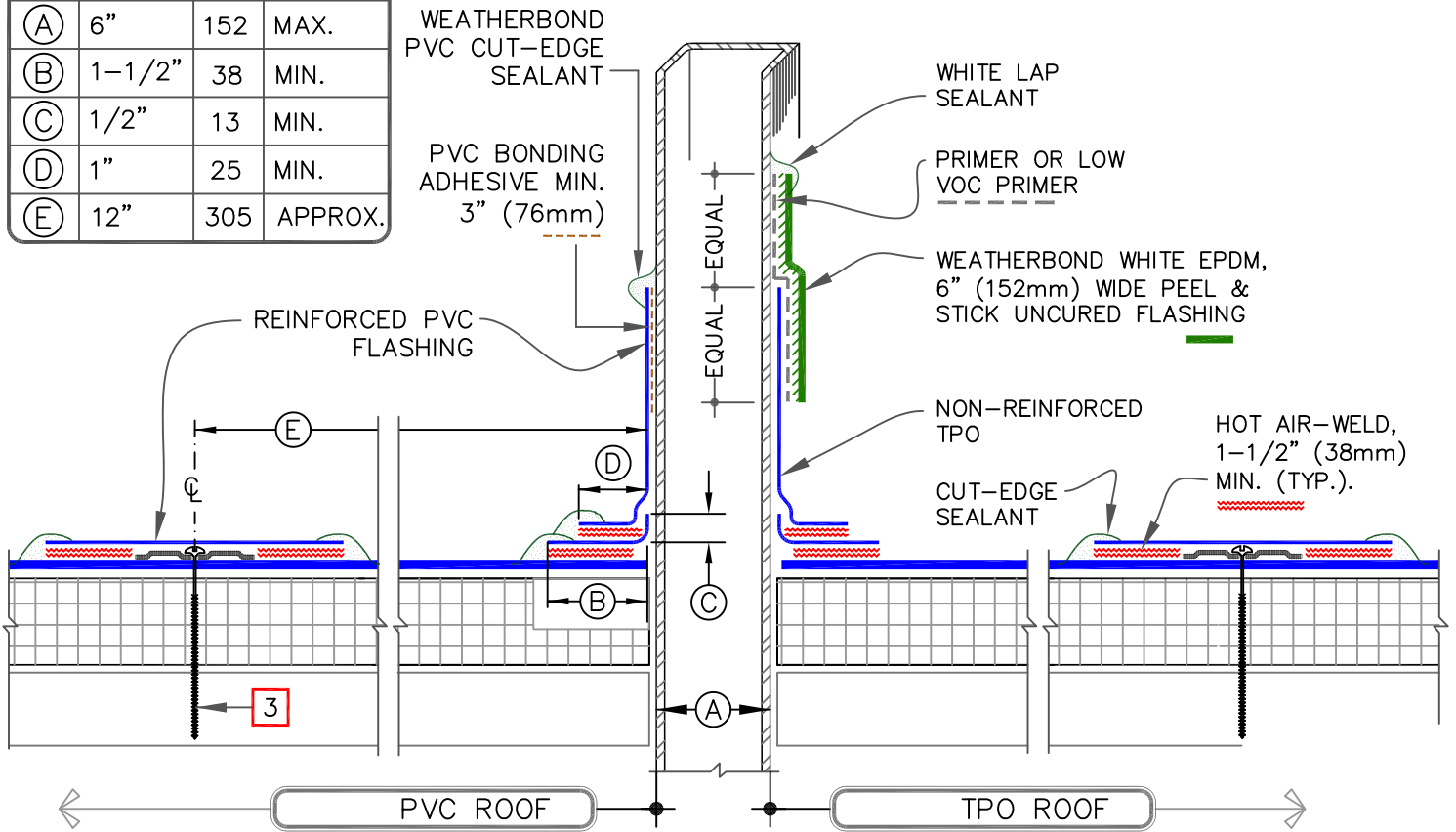
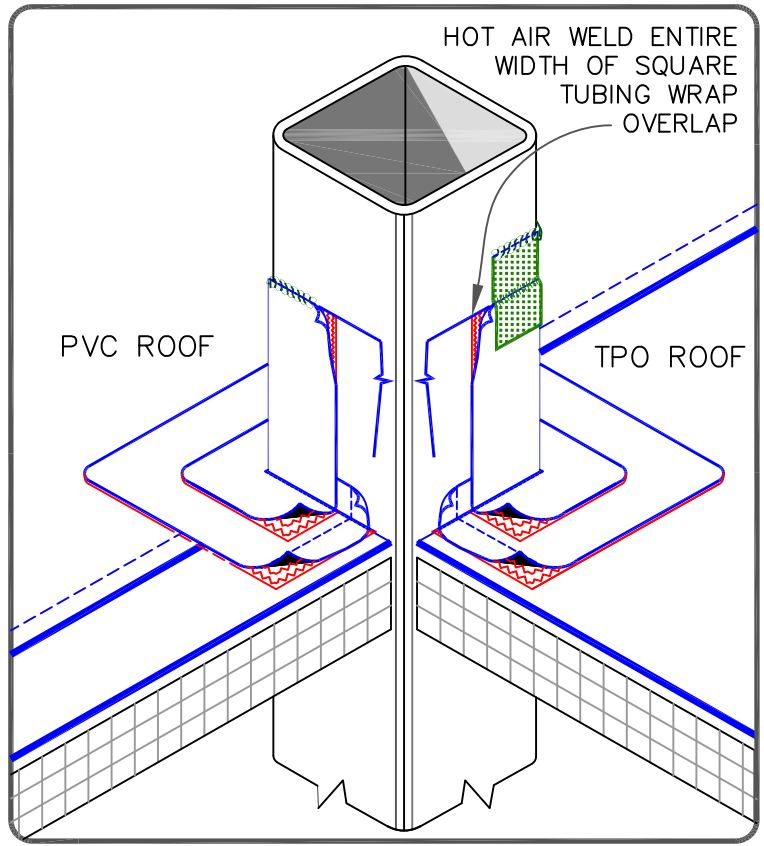

TABLE: FASTENER TYPES ON MECHANICALLY FASTENED ROOF ASSEMBLY

DECK TYPE	FASTENERS	PLATES
STEEL, WOOD	HPWX	
CONCRETE	APPROVED CONCRETE FASTENER	HPWX

NOTES:

1. REMOVE ALL EXISTING LEAD AND FLASHING MATERIAL BEFORE INSTALLING PRE-FABRICATED SQUARE TUBE WRAP.
2. TEMPERATURE OF THE TUBE PENETRATION MUST NOT EXCEED 140°F (60°C) WHEN USING PVC AND 160°F (71°C) WHEN USING TPO FLASHING.
3. WEATHERBOND FASTENERS & SEAM FASTENING PLATES FOR MECHANICALLY FASTENED SYSTEM (NOT REQUIRED ON ADHERED SYSTEM). SEE TABLE ABOVE.
4. REGARDLESS OF THE FIELD MEMBRANE THICKNESS, WEATHERBOND "T-JOINT" COVERS ARE REQUIRED OVER THE SPLICE INTERSECTIONS OF THE SPLIT PIPE SEAL. IF PRE-FABRICATED SPLIT PIPE SEAL IS A "CFA" LABELED PART, NO "T-JOINT" COVERS ARE REQUIRED.



FIELD-FABRICATED SQUARE TUBE FLASHING

- WEATHERBOND THERMOPLASTIC REINFORCED MEMBRANE
- APPROVED SUBSTRATE
- SEE NOTE

THERMOPLASTIC ROOFING SYSTEM
WBPC-8.4