

NOTES:

1. ON MECHANICALLY ATTACHED SYSTEMS, HPWX FASTENERS AND PLATES ARE REQUIRED OVER STEEL AND WOOD DECKS. ON CONCRETE DECKS, APPROVED CONCRETE FASTENERS ARE USED WITH HPWX PLATES.
2. POSITION SEAM FASTENING PLATES BEYOND NON-REINFORCED ENCAPSULATED EDGE.
3. APPROXIMATELY 1/8" (3mm) DIAMETER BEAD OF CUT-EDGE SEALANT IS REQUIRED ON CUT EDGES OF WEATHERBOND REINFORCED TPO MEMBRANE AND RECOMMENDED ON CUT EDGES OF WEATHERBOND PVC MEMBRANE.
4. WHEN USING 60 OR 80-MIL MEMBRANE, APPLY A 4-1/2" (114mm) DIAMETER WEATHERBOND T-JOINT COVER AT ALL FIELD SPLICE INTERSECTIONS.

DIMENSIONS	mm	
(A)	5-1/2"	140 APPROX.
(B)	1/2"	13 APPROX.

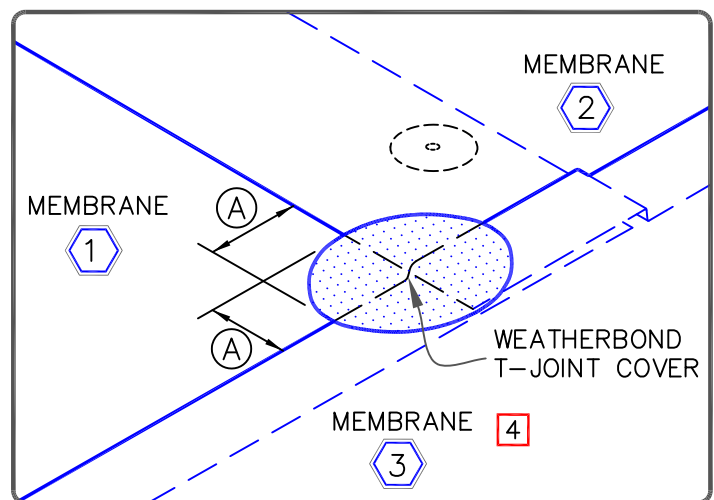

MECHANICALLY ATTACHED MEMBRANE SPLICE

- WEATHERBOND THERMOPLASTIC REINFORCED MEMBRANE
- APPROVED SUBSTRATE
- SEE NOTE

THERMOPLASTIC ROOFING SYSTEM
WBPA-2.1