

POSITION MEMBRANE TO ALLOW AN APPROXIMATE 3" (76mm) OVERLAP. MARK THE BOTTOM SHEET WITH AN INDELIBLE MARKER 1/2" (13mm) FROM THE EDGE OF THE TOP SHEET AS SHOWN. THE PRE-MARKED LINE ON THE MEMBRANE EDGE CAN ALSO BE USED AS A GUIDE.

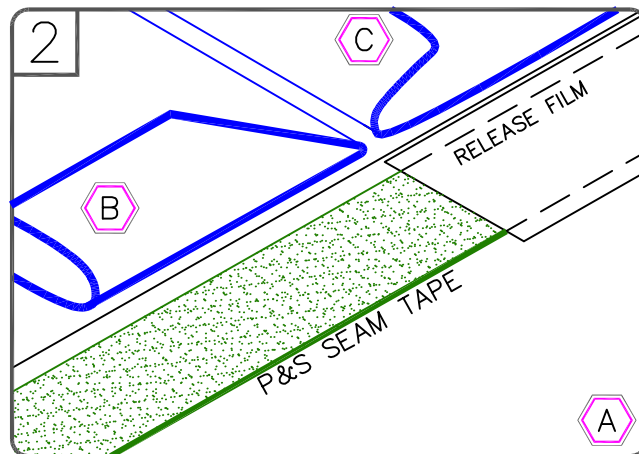

FOLD SHEETS BACK AS SHOWN. APPLY EPDM PRIMER TO THE SPLICE AREA ON BOTH SURFACES AND ALLOW TO PROPERLY DRY. APPLY P&S SEAM TAPE WITH RELEASE FILM ALIGNED WITH MARKER LINE.

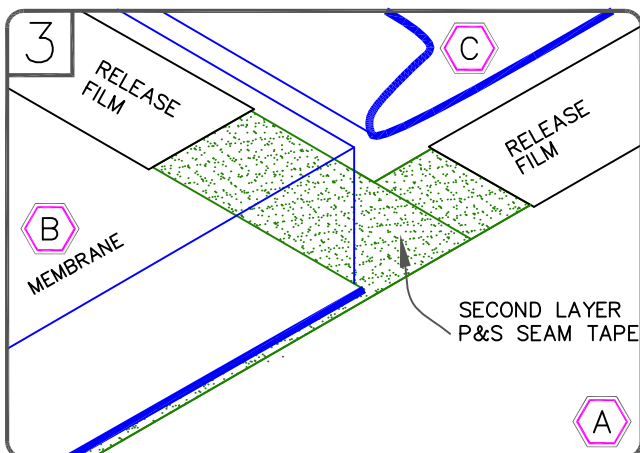

SPLICE SHEET B TO SHEET A AND APPLY SECOND PIECE OF P&S SEAM TAPE BETWEEN SHEET B AND C. TRIM RELEASE FILM AS SHOWN.

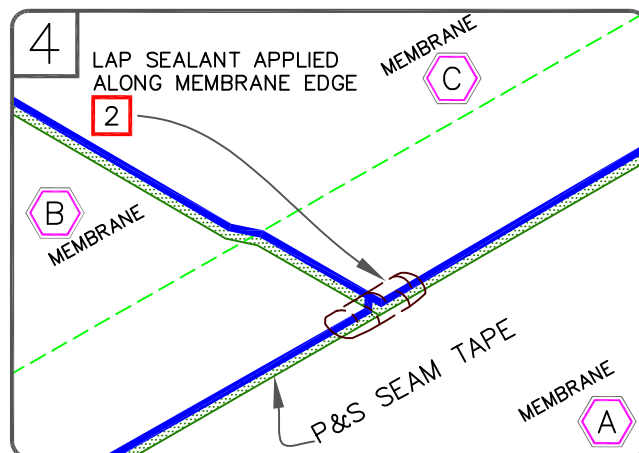

SPLICE SHEET C TO SHEET A AND B, PRESS TOP SHEET ONTO BOTTOM SHEET USING HAND PRESSURE TOWARDS THE OUTER EDGE OF THE SPLICE AND ROLL THE SPLICE AREA WITH A 2" (51mm) WIDE STEEL ROLLER.

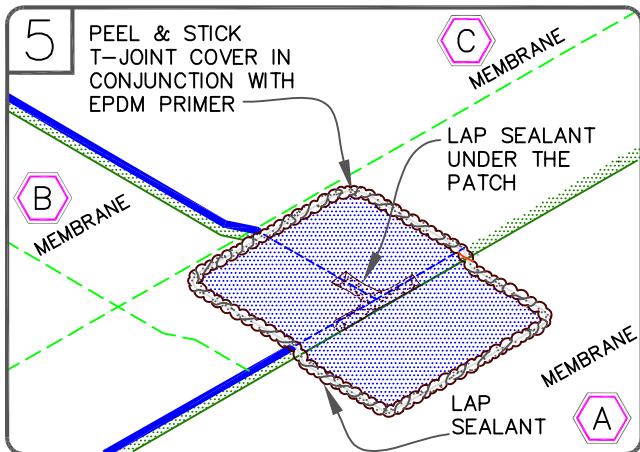

APPLY PEEL & STICK T-JOINT COVER OR 6" (152mm) WIDE SECTION OF PEEL & STICK UNCURED EPDM FLASHING CENTERED OVER THE INTERSECTING POINT OF THE LEADING EDGES OF THE FIELD SPLICE INTERSECTION AS SHOWN.

NOTES:

1. THE USE OF LAP SEALANT ALONG ENTIRE SPLICE EDGE IS OPTIONAL, EXCEPT AT CUT EDGES OF REINFORCED MEMBRANE AND TAPE OVERLAPS. REFER TO [WBRC-2.1A](#)
2. APPLY LAP SEALANT ALONG THE EDGE OF THE MEMBRANE SPLICE UNDER THE 6"X6" (152mm X 152mm) T-JOINT COVER, COVERING THE EXPOSED SPLICE TAPE 1/2" (13mm) IN EACH DIRECTION FROM THE SPLICE INTERSECTION.
3. REFER TO [DETAIL WBRC-2.1B](#) FOR WARRANTY PROJECTS EXCEEDING 20-YEARS OR WHEN USING 90-MIL MEMBRANE.



P&S SEAM TAPE SPLICE INTERSECTION

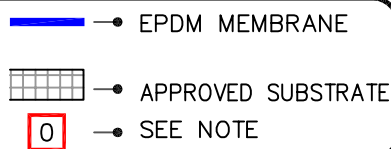

EPDM ROOFING SYSTEM

WBRC-2.2