

A 1-1/2" (38mm) RING SHANK NAILS @ 6" (15cm) O.C. MAXIMUM

B HPW FASTENERS @ 12" (30cm) O.C. OR RING-SHANK NAILS @ 4" (10cm) O.C. & STAGGERED 3/4" (2cm) O.C.

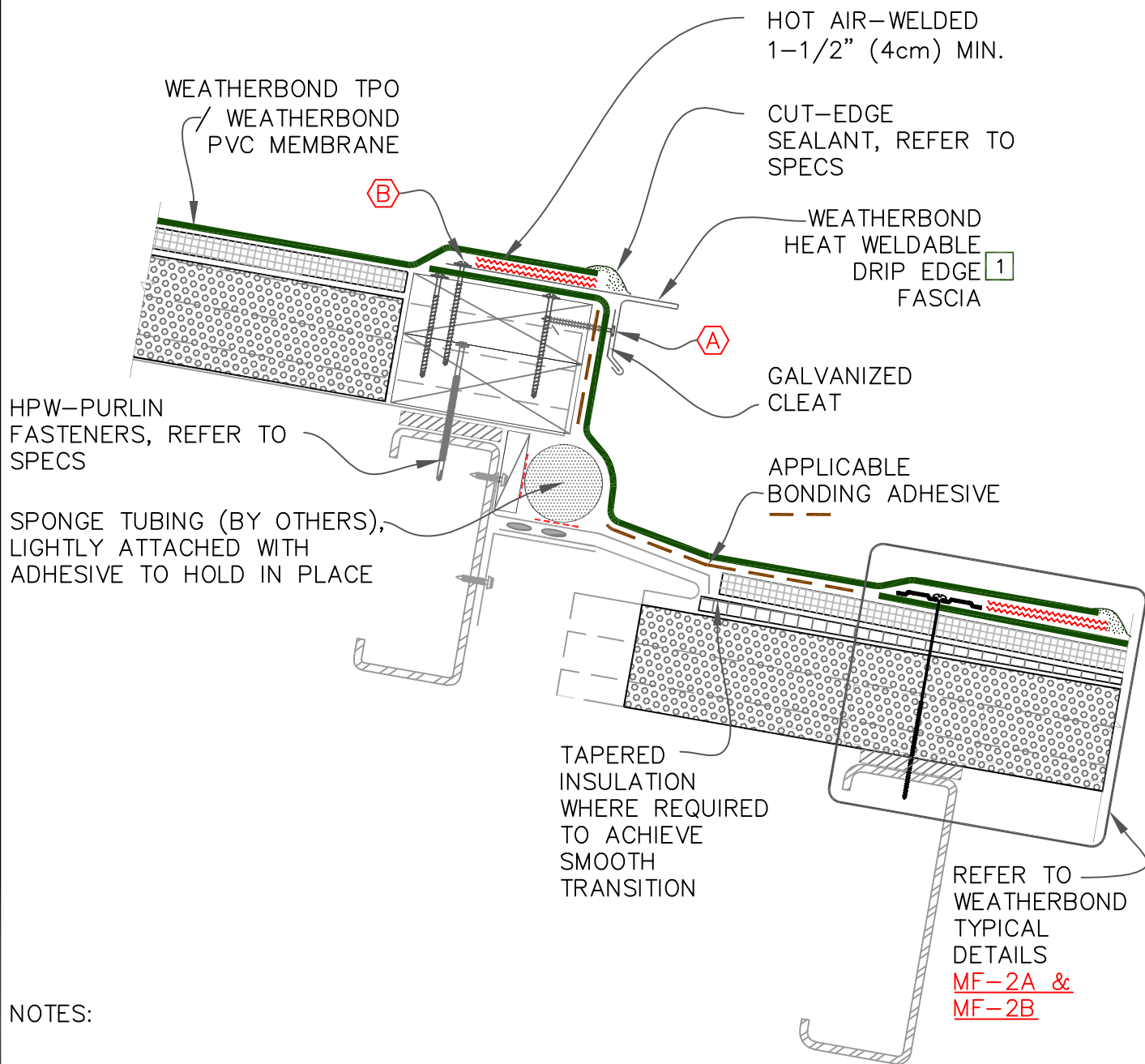

NOTES:

1. EXTEND OUT SHEET METAL MIN. 2" (5cm)
2. REFER TO [MR Z1.1](#) & [MR Z1.2](#) AT THE END OF THIS SECTION.



EXPANSION JOINT AT STEP DOWN CONDITION

	• HIGH DENSITY RECOVER BOARD
	• IN-FILL INSULATION
	• SEE NOTE(S)

METAL RETROFIT

MR | T3.1