

NOTES:

1. REFER TO [WEATHERBOND 200 INSTALLATION INSTRUCTION MANUAL](#) FOR STEP-BY-STEP INSTALLATION PROCEDURES.
2. WOOD NAILER MUST EXTEND PAST TOTAL WIDTH OF GRAVEL STOP DECK FLANGE.
3. WHEN METAL FASCIA BY OTHERS IS USED, FASTENER TYPE AND FASTENING FREQUENCY SHALL BE RECOMMENDED BY METAL EDGE MANUFACTURER.

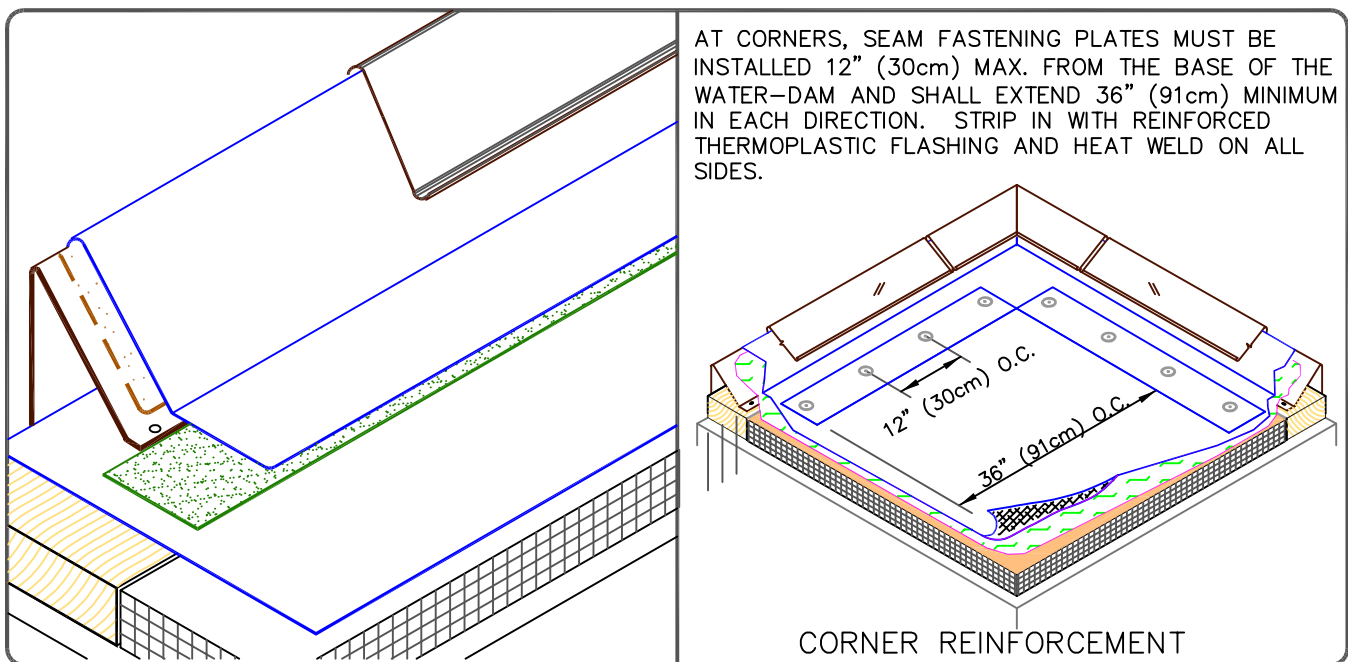

WEATHERBOND 200

	→ WEATHERBOND FLEECE MEMBRANE
	→ FLEXIBLE DASH
	→ APPROVED SUBSTRATE
	→ SEE NOTE(S)

THERMOPLASTIC
 WEATHERBOND
 FLEECE ADHERED
WBF-1.4