

NOTES:

1. REFER TO [WEATHERBOND 300 INSTALLATION INSTRUCTION MANUAL](#) FOR STEP-BY-STEP INSTALLATION PROCEDURES.
2. WOOD NAILER MUST EXTEND PAST TOTAL WIDTH OF GRAVEL STOP DECK FLANGE.
3. WHEN METAL FASCIA BY OTHERS IS USED, FASTENER TYPE AND FASTENING FREQUENCY SHALL BE RECOMMENDED BY METAL EDGE MANUFACTURER.
4. APPROXIMATELY 1/8" (0.5cm) DIAMETER BEAD OF CUT-EDGE SEALANT IS REQUIRED ON CUT EDGES OF REINFORCED TPO MEMBRANE.

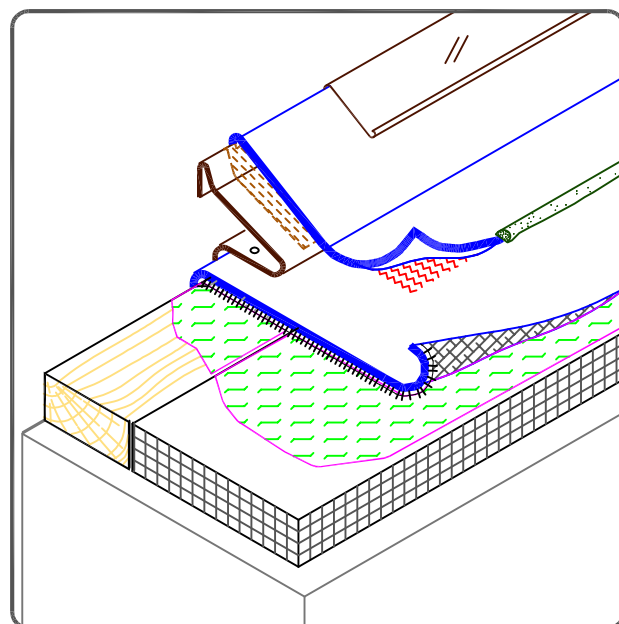

WEATHERBOND 300

- WEATHERBOND FLEECE MEMBRANE
- FLEXIBLE DASH
- APPROVED SUBSTRATE
- SEE NOTE(S)

THERMOPLASTIC WEATHERBOND FLEECE ADHERED  
**WBF-1.5**