

PVC ONLY  
(NOT FOR TPO)

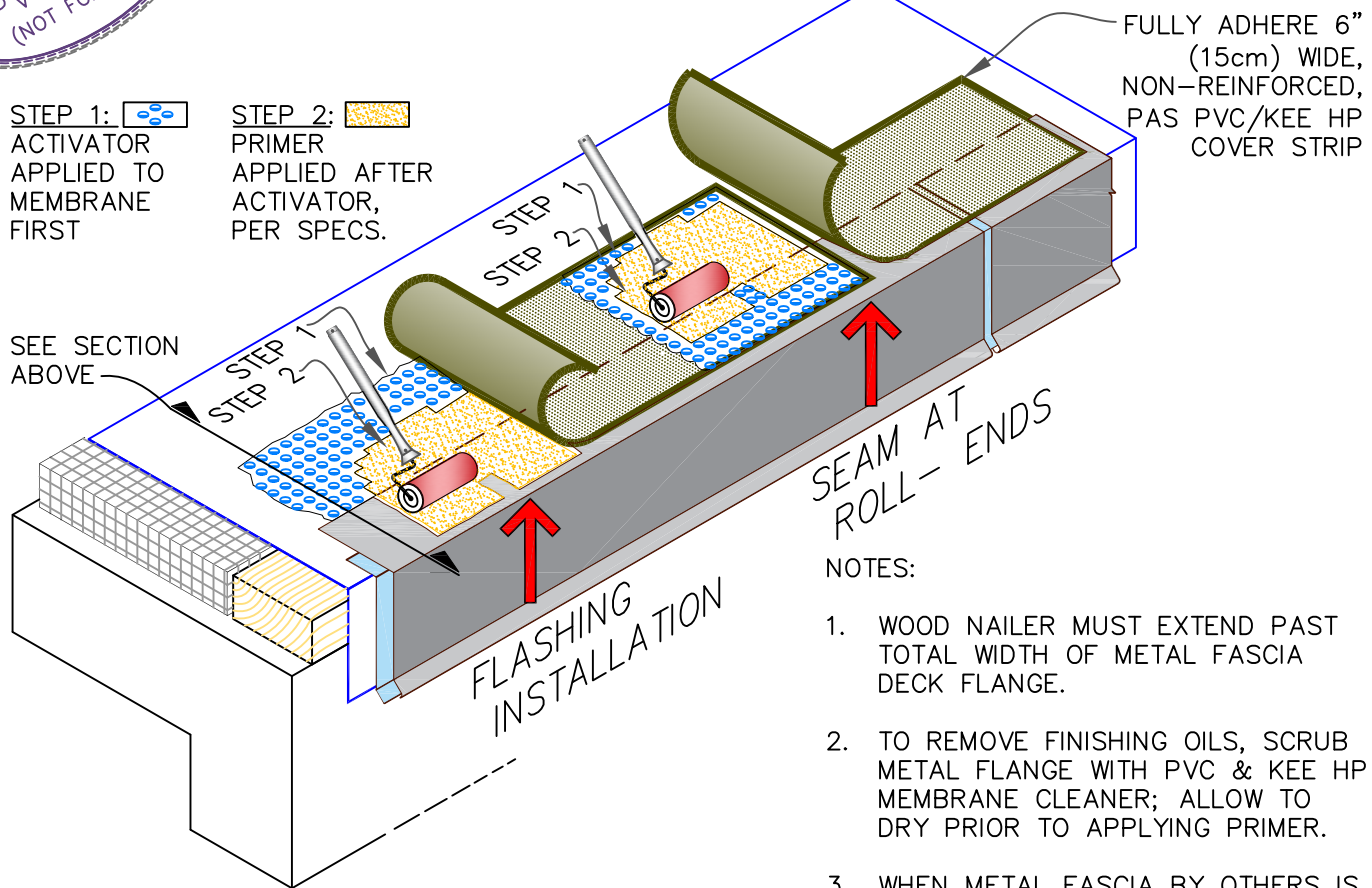

NOTES:

1. WOOD NAILER MUST EXTEND PAST TOTAL WIDTH OF METAL FASCIA DECK FLANGE.
2. TO REMOVE FINISHING OILS, SCRUB METAL FLANGE WITH PVC & KEE HP MEMBRANE CLEANER; ALLOW TO DRY PRIOR TO APPLYING PRIMER.
3. WHEN METAL FASCIA BY OTHERS IS USED, FASTENER TYPE AND FASTENING FREQUENCY SHALL BE RECOMMENDED BY METAL EDGE MANUFACTURER.
4. TO ENSURE TPO PEEL & STICK COVER STRIP CONFORMS TO STEP-OFFS, HEAT COVER STRIP AT SPLICE INTERSECTIONS PRIOR TO ROLLING.



PEEL & STICK PVC/KEE HP COVER STRIP

- PVC MEMBRANE
- APPROVED SUBSTRATE
- SEE NOTE

THERMOPLASTIC ROOFING SYSTEM

WBPC-1.4