

DIMENSIONS		cm	
(A)	6"	15	MAX.
(B)	1-1/2"	4	MIN.
(C)	1/2"	1.5	MIN.
(D)	1"	2.5	MIN.
(E)	12"	30	APPROX.

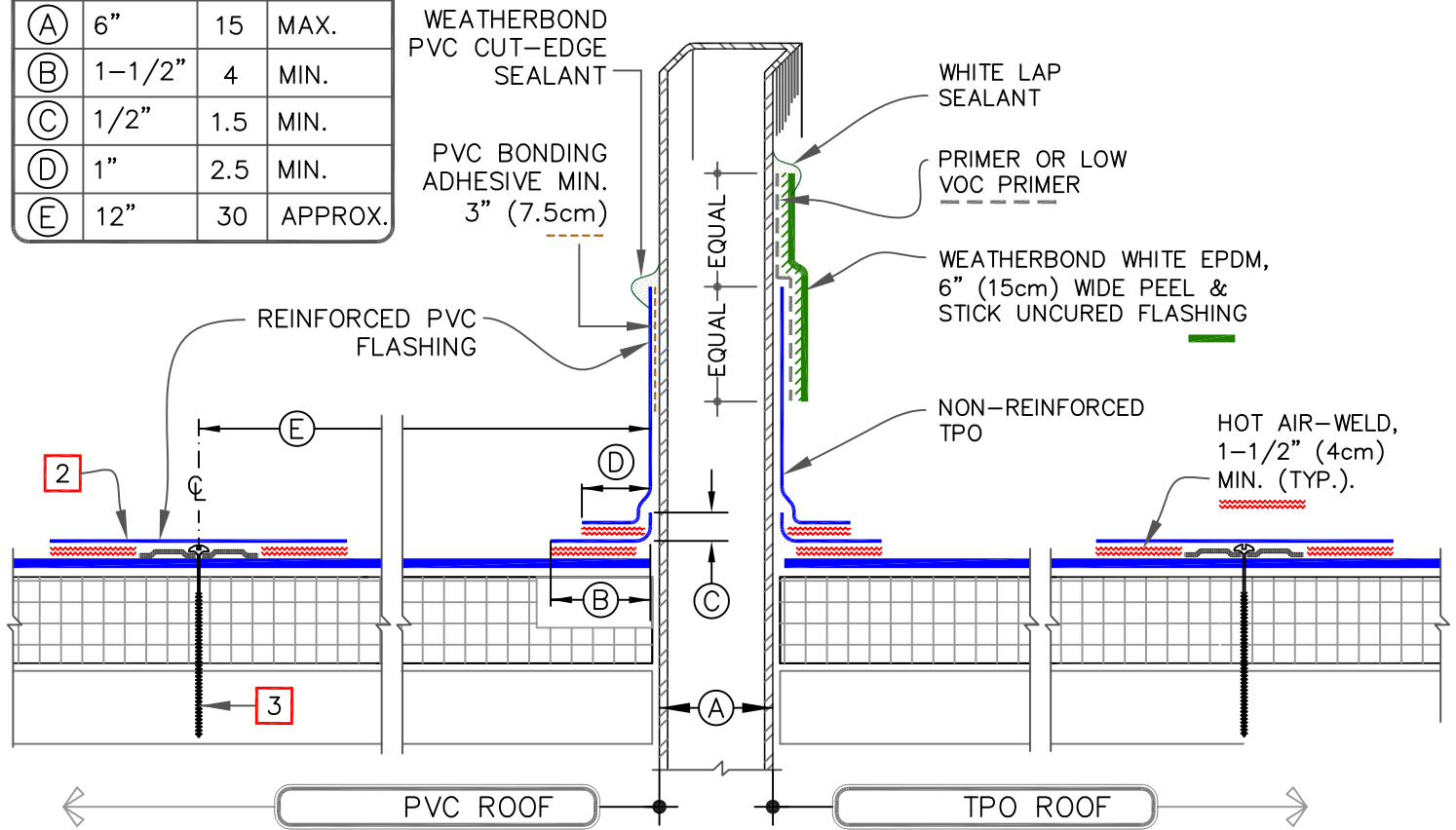
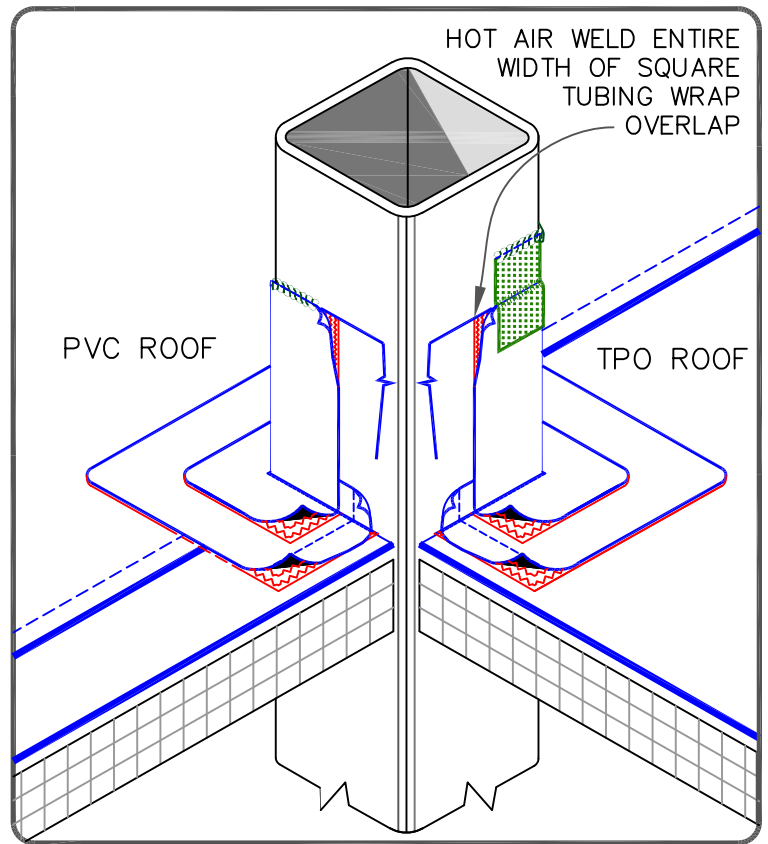

TABLE: FASTENER TYPES ON MECHANICALLY FASTENED ROOF ASSEMBLY

DECK TYPE	FASTENERS	PLATES
STEEL, WOOD	HPWX	
CONCRETE	APPROVED CONCRETE FASTENER	HPWX

NOTES:

1. REMOVE ALL EXISTING LEAD AND FLASHING MATERIAL BEFORE INSTALLING PRE-FABRICATED SQUARE TUBE WRAP.
2. TEMPERATURE OF THE TUBE PENETRATION MUST NOT EXCEED 140°F (60°C) WHEN USING PVC AND 160°F (71°C) WHEN USING TPO FLASHING.
3. WEATHERBOND FASTENERS & SEAM FASTENING PLATES FOR MECHANICALLY FASTENED SYSTEM (NOT REQUIRED ON ADHERED SYSTEM). SEE TABLE ABOVE.
4. T-JOINT COVERS ARE NOT REQUIRED ON STANDARD COLORS (WHITE, TAN, GRAY), FOR ADDITIONAL COLORS IT IS REQUIRED TO COVER T-JOINTS



FIELD-FABRICATED SQUARE TUBE FLASHING

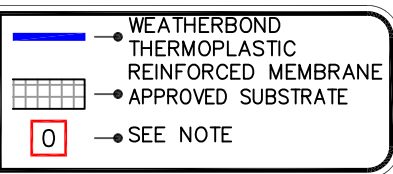

THERMOPLASTIC ROOFING SYSTEM  
WBPC-8.4