

POSITION MEMBRANE TO ALLOW AN APPROXIMATE 4" (10cm) OVERLAP. MARK THE BOTTOM SHEET WITH AN INDELIBLE MARKER 1/2" (1.5cm) FROM THE EDGE OF THE TOP SHEET AS SHOWN. THE PRE-MARKED LINE ON THE MEMBRANE EDGE CAN ALSO BE USED AS A GUIDE.

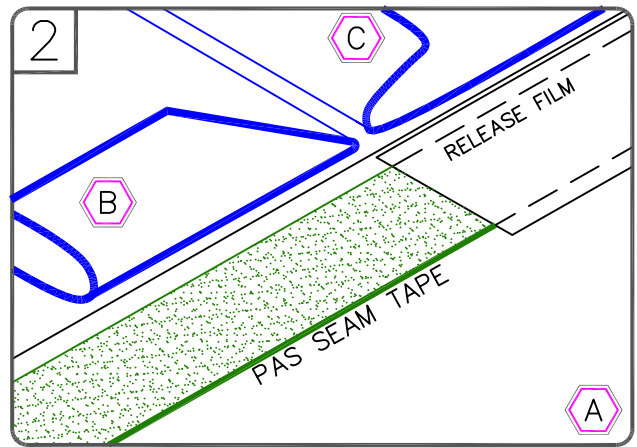

FOLD SHEETS BACK AS SHOWN. APPLY EPDM PRIMER TO THE SPLICE AREA ON BOTH SURFACES AND ALLOW TO PROPERLY DRY. APPLY PAS SEAM TAPE WITH RELEASE FILM ALIGNED WITH MARKER LINE.

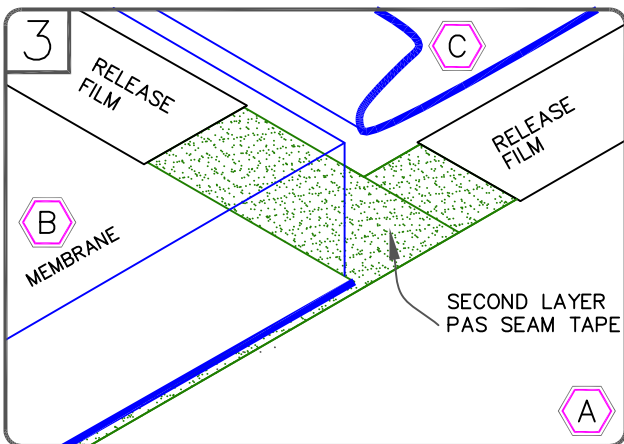

SPLICE SHEET B TO SHEET A AND APPLY SECOND PIECE OF PAS SEAM TAPE BETWEEN SHEET B AND C. TRIM RELEASE FILM AS SHOWN.

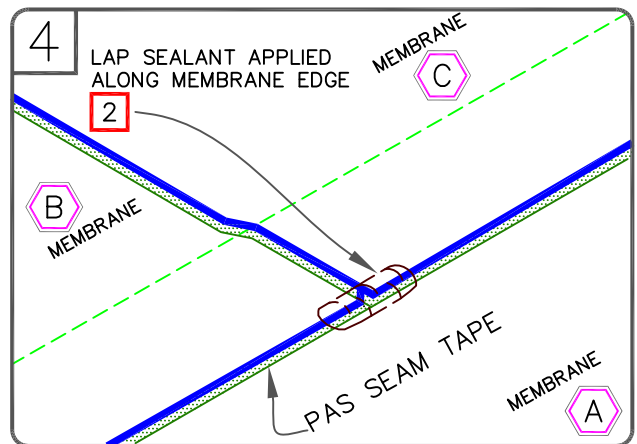

SPLICE SHEET C TO SHEET A AND B, PRESS TOP SHEET ONTO BOTTOM SHEET USING HAND PRESSURE TOWARDS THE OUTER EDGE OF THE SPLICE AND ROLL THE SPLICE AREA WITH A 2" (5cm) WIDE STEEL ROLLER.

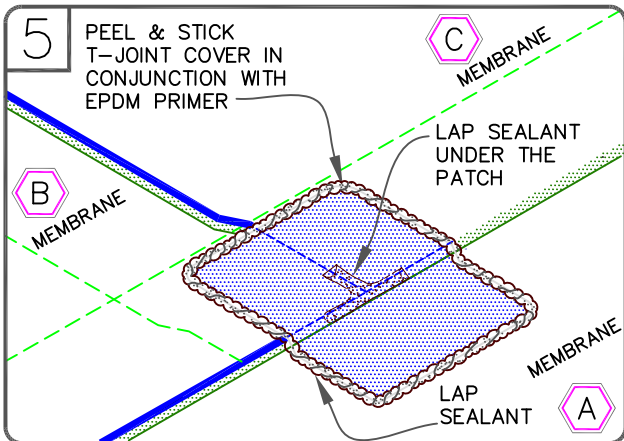

APPLY PEEL & STICK T-JOINT COVER OR 6" (15cm) WIDE SECTION OF PEEL & STICK UNCURED EPDM FLASHING CENTERED OVER THE INTERSECTING POINT OF THE LEADING EDGES OF THE FIELD SPLICE INTERSECTION AS SHOWN.

NOTES:

1. APPLY LAP SEALANT ALONG THE EDGE OF THE MEMBRANE SPLICE BELOW THE 6" (15cm) T-JOINT COVER, COVERING THE EXPOSED SPLICE TAPE 1/2" (1.5cm) IN EACH DIRECTION FROM THE SPLICE INTERSECTION.
2. APPLY LAP SEALANT AT CUT EDGES OF REINFORCED MEMBRANE AND TAPE OVERLAPS. REFER TO [DETAIL WBRC-2.1](#).
3. REFER TO [DETAIL WBRC-2.2](#) WHEN USING 90-MIL MEMBRANE.



PAS SEAM TAPE SPLICE INTERSECTION

- EPDM MEMBRANE
- APPROVED SUBSTRATE
- SEE NOTE

EPDM ROOFING SYSTEM

WBRC-2.2