

NOTES:

1. WHEN MECHANICAL FASTENERS ARE USED TO PENETRATE THE METAL COUNTER-FLASHING, USE EPDM WASHERS, APPLY WATER CUT-OFF MASTIC UNDER THE COUNTER-FLASHING OR CAULK THE FASTENER HEADS.
2. SEAM FASTENING PLATES/FASTENERS MAY BE INSTALLED INTO THE VERTICAL SUBSTRATE.
3. HPWX FASTENERS AND POLYMER SEAM PLATES ARE REQUIRED ON MECHANICALLY FASTENED ROOFING SYSTEMS OVER STEEL DECKS.
4. IF THE VERTICAL SPLICE ON THE CURB FLASHING IS NOT LOCATED AT THE CORNER, USE DETAIL [WBRC-2.3](#) FOR EPDM MEMBRANE SPLICES AT ANGLE CHANGES.

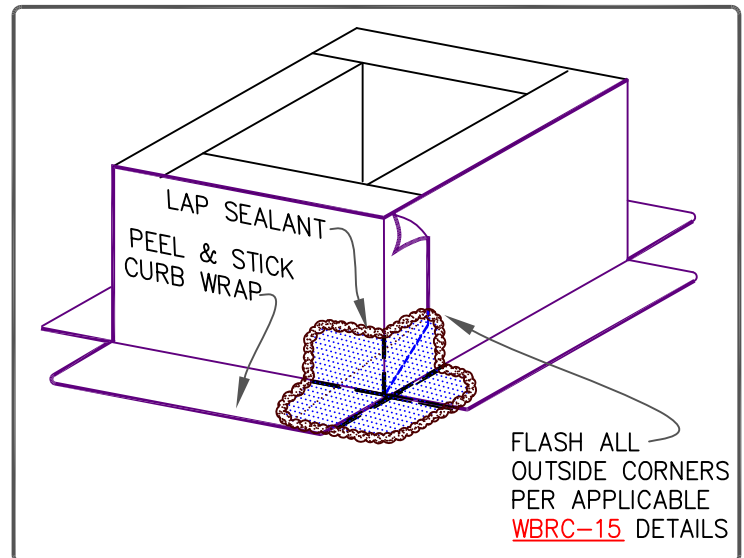

PEEL & STICK CURB WRAP	→ EPDM MEMBRANE → APPROVED SUBSTRATE → SEE NOTE
------------------------	---

EPDM ROOFING SYSTEM
WBRC-5.2