

6" (15cm) WIDE CONCEALED JOINT UNDER PLATE, CENTRALLY ALIGNED BETWEEN TWO FASCIA PIECES

③ UNDER PLATE - TYP. FASCIA

3/8" (1cm) DIA. BEAD OF CONTINUOUS SINGLE-PLY UNIVERSAL SEALANT, MAX. 1/2" (1.5cm) FROM EDGES

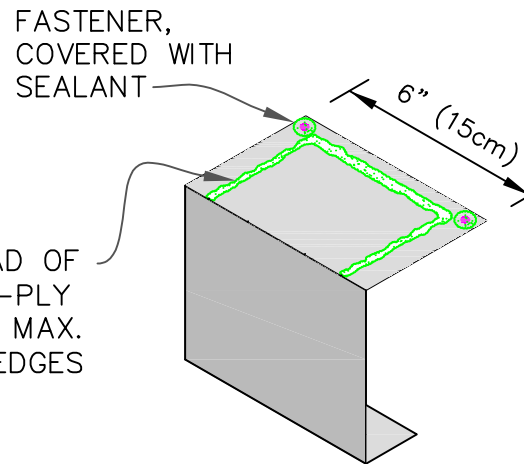

6" (15cm) WIDE, 24 GAUGE, CONCEALED JOINT UNDER PLATE, PROFILE TO MATCH WITH C-CHANNEL, CENTRALLY ALIGNED BETWEEN TWO C-CHANNEL FASCIAS

④ UNDER PLATE: C-CHANNEL

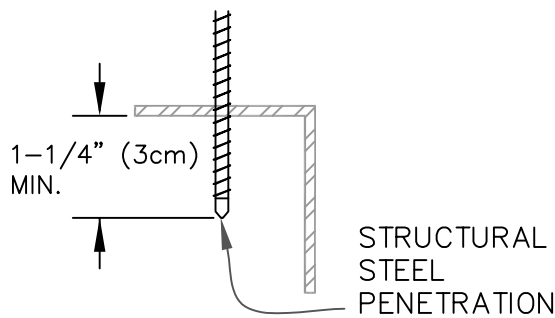

⑤ FASTENER INTO STRUCTURAL STEEL

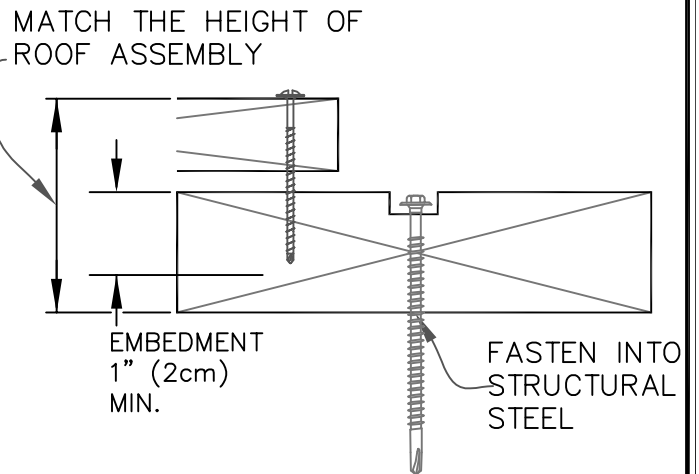

⑥ FASTENER INTO WOOD

COMMON DETAILS (EPDM, TPO, PVC)



ENLARGED DETAILS

- HIGH DENSITY RECOVER BOARD
- IN-FILL INSULATION
- SEE NOTE(S)

METAL RETROFIT
MR | Z1.1