

DIMENSIONS		cm
(A)	3-1/2"	9
(B)	1"	2.5
(C)	3/4	2
(D)	4" OR 6"	10 OR 15

NOTE:  
ALL 1-1/2" (4cm) RING SHANK NAILS MUST HAVE 1" (2.5cm) MINIMUM EMBEDMENT INTO WOOD

**(A)** ES-1 COMPLIANT FASCIA PROFILE  
24 GAUGE (0.59 mm) THICK - 10' (3m) LENGTH

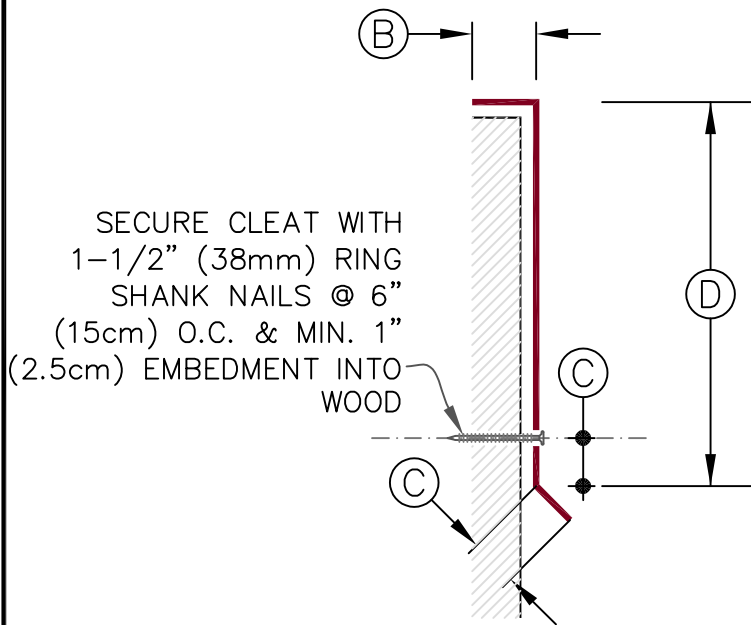

**(B)** GALVANIZED METAL CLEAT  
22 GAUGE (0.75 mm) THICK

TABLE 1: (TEST DATA)		
ES-1	COMPLIANT	
RE-1	424	PSF (POUNDS/SQUARE FOOT)
	62.62	(kilogram/sq.meter)
	614	pascals (Pa)
RE-2	435	PSF (POUNDS/SQUARE FOOT)
	64.24	(kilogram/sq.meter)
	629.95	pascals (Pa)



ANSI / SPRI ES-1 COMPLIANT FASCIA - SHOP FABRICATED

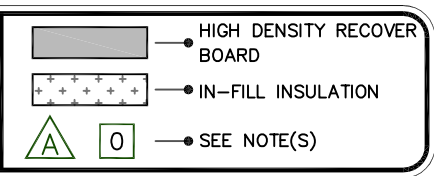

METAL RETROFIT  
MR | Z1.2