

WeatherBond TPO Fleece

Mechanically Attached Roofing System

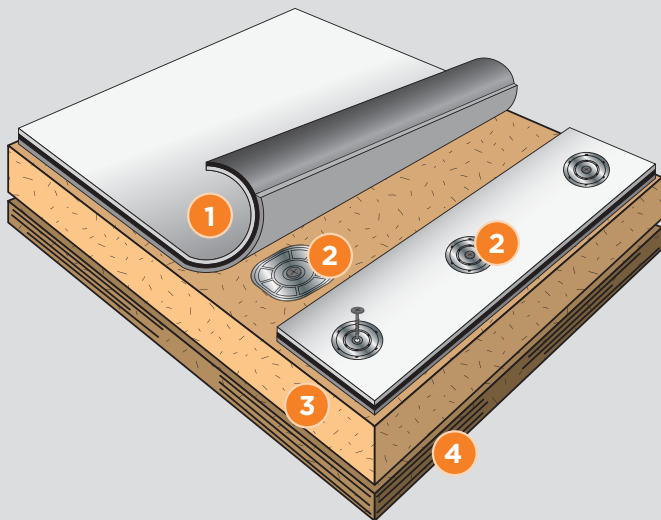

Typical Application

- 1 WeatherBond TPO Fleece
- 2 Fasteners and Plates
- 3 Acceptable Insulation
- 4 Approved Roof Deck

Colors:	White, Gray, Tan
Standard Thicknesses:	100, 115 and 135
Standard Widths:	6' and 12'
Standard Lengths:	50', 75' and 100'

System Features And Benefits:

- UL Class A fire rating
- 12' sheet reduces seams by over 75% compare to Modified Bitumen sheets
- ENERGY STAR® qualification for White and Tan WeatherBond TPO Fleece
- Exceptional puncture resistance
- Reflectivity warranty available
- Ideal for recovering smooth BUR, Modified Bitumen or Mineral Cap Sheet
- WeatherBond TPO Fleece's smooth top-ply surface resists dirt pickup and bacteria growth and provides for a clean monolithic seam weld
- Membranes resist hail damage and tolerate frequent foot traffic
- WeatherBond membranes are considered environmentally friendly as they do not contain chlorine or plasticizers
- Industry-leading OctaGuard XT Weathering Package provides improved weatherability, durability and long-term rooftop performance

Installation

The WeatherBond TPO Fleece Mechanically Attached Roofing System utilizes 45-, 60- or 80-mil white, gray or tan VersiWeld thermoplastic polyolefin (TPO) membrane laminated to a non-woven polyester fleece backing.

Insulation is mechanically attached to an acceptable roof deck. WeatherBond TPO Fleece membrane sheets are mechanically attached to the deck with WeatherBond's HPWX or HPW-XL Fasteners and Plates. Adjoining sheets are overlapped and joined together with a minimum 1½"-wide hot-air weld.

The above information represents a typical WeatherBond TPO Fleece Mechanically Attached Roofing System application. Refer to WeatherBond's published specifications and details for more complete information.

Certified Fabricated Accessories

Certified Fabricated Accessories (CFAs) are the only factory-fabricated TPO accessories that meet the stringent quality tolerances.



WB
WEATHERBOND
 ROOFING SYSTEMS

Single-Ply Simplified

New Construction							Re-roofing		
Existing or New Deck Type	Steel	Plywood or OSB	Lt. Wt. Concrete	Structural Concrete	Wood Planks	Gypsum & Fibrous Cement	Smooth-Surface BUR	Gravel-Surfaced BUR	Existing Single-Ply
Deck Overlayment Required	Insulation	No	No	No	Insulation	Insulation	No	Insulation	No
Insulations	Polyiso, Recovery Board, Dens-Deck, Securock or Recovery Board over Polystyrene						←	Refer to New Construction	
Insulation Attached By	Fasteners and Plates						←	Refer to New Construction	
Membrane Attached By	HPWX Fasteners & Plates; HPW-XL Fasteners & Plates	HPWX Fasteners & Plates; HPW-XL Fasteners & Plates	Contact WeatherBond	Contact WeatherBond	HPWX Fasteners & Plates	Contact WeatherBond	←	Refer to New Construction	

FOR TEAR-OFF OPTIONS REFER TO NEW CONSTRUCTION ABOVE.
For current code approvals, visit WeatherBond's website or contact a design analyst.



WEATHERBOND
ROOFING SYSTEMS

Single-Ply Simplified

P.O. Box 251 | Plainfield, PA 17081 | 866.471.5125 | FAX: 717.960.4034 | www.weatherbondroofing.com

© 2017 WeatherBond. 12.06.17 REPRINT REQUEST CODE: 609325 - "WeatherBond TPO Fleece Mechanically Attached System Sheet"
WeatherBond is a trademark of WeatherBond. ENERGY STAR is a registered trademark of the U.S. Government.
*ENERGY STAR qualification is only valid in the U.S. Elvaloy is a registered trademark of DuPont.