

WeatherBond EPDM

Fully Adhered Roofing System

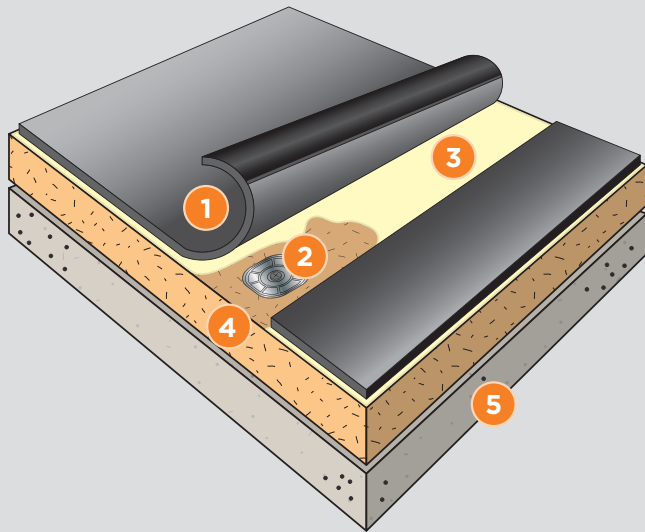

Typical Application

- 1 WeatherBond EPDM Membrane with Pre-Applied Seam Tape
- 2 Fasteners and Plates
- 3 EPDM Bonding Adhesive
- 4 Acceptable Insulation
- 5 Approved Roof Deck

Colors:	Black, White
Standard Thicknesses:	40-, 60- and 90-mil
Standard Widths:	10'-30'
Standard Lengths:	50'-200'

System Features And Benefits:

- In colder climates, dark-colored EPDM reduces heating costs
- Industry-leading UV resistance of 41,580 kJ/m²
- Full thickness of weathering material, no internal scrim
- 465% elongation offers superior hail damage resistance
- Lowest global warming potential, acid rain and smog impact according to EPA's TRACI model
- Zero (no growth) rating for fungal growth
- Full line of Peel & Stick accessories
- Lightweight requirements
- No slope restrictions

Installation

The WeatherBond fully adhered roofing system utilizes 45-, 60- and 90-mil non-reinforced membranes. Additionally, WeatherBond white membranes may also be utilized to meet ENERGY STAR[®], Title 24 and CRRC requirements, and contribute toward LEED[®] credits.

Insulation is either mechanically fastened to the roof deck every 2 square feet or adhered with a WeatherBond approved adhesive. Membrane is adhered to the insulation with WeatherBond EPDM Bonding Adhesive. Adjoining sheets of EPDM are spliced together a minimum of 3" using WeatherBond's EPDM Primer and Peel and Stick Seam Tape or WeatherBond EPDM with Pre-Applied Seam Tape Technology.

The above information represents a typical WeatherBond Fully Adhered Roofing System. Refer to WeatherBond's installation instructions for more complete information.



WEATHERBOND
ROOFING SYSTEMS

Single-Ply Simplified

Existing or New Deck Type	New Construction						Re-roofing		
	Steel	Plywood or OSB	Lt. Wt. Concrete	Structural Concrete	Wood Planks	Gypsum & Fibrous Cement	Smooth-Surface BUR	Gravel-Surfaced BUR	Existing Single-Ply
Insulation Required	Yes	No	*Refer to Specs	No	No	Yes	No	Yes	Yes
Recommended Insulations	Polyiso, OSB, XFP or XFP over Polystyrene						← Refer to New Construction		
Insulation Attached By	DASH Adhesive (Non-Penetrating) or Fasteners and Plates						← Refer to New Construction		
Membrane Attached By	Approved EPDM Bonding Adhesive						← Refer to New Construction		

FOR TEAR-OFF OPTIONS REFER TO NEW CONSTRUCTION ABOVE.
 For current code approvals visit WeatherBond's web site or contact a design analyst.
 * Refer to WeatherBond's current specifications for requirements.



WEATHERBOND
ROOFING SYSTEMS

Single-Ply Simplified

P.O. Box 251 | Plainfield, PA 17081 | 866.471.5125 | FAX: 717.960.4034 | www.weatherbondroofing.com

© 2017 WeatherBond. 12.05.17 REPRINT REQUEST CODE: 609328 - "WeatherBond EPDM Fully Adhered System Sheet"
 WeatherBond is a trademark of WeatherBond.
 ENERGY STAR is a registered trademark owned by the U.S. Government. * ENERGY STAR qualification is only valid in the U.S.