

NEW CONSTRUCTION OR RE-ROOF/TEAR OFF PROJECTS WITH WEATHERBOND APPROVED INSULATION

RE-ROOF/NO TEAR OFF PROJECTS WITH POLYISOCYANURATE LESS THAN 1-1/2" (38mm) THICK

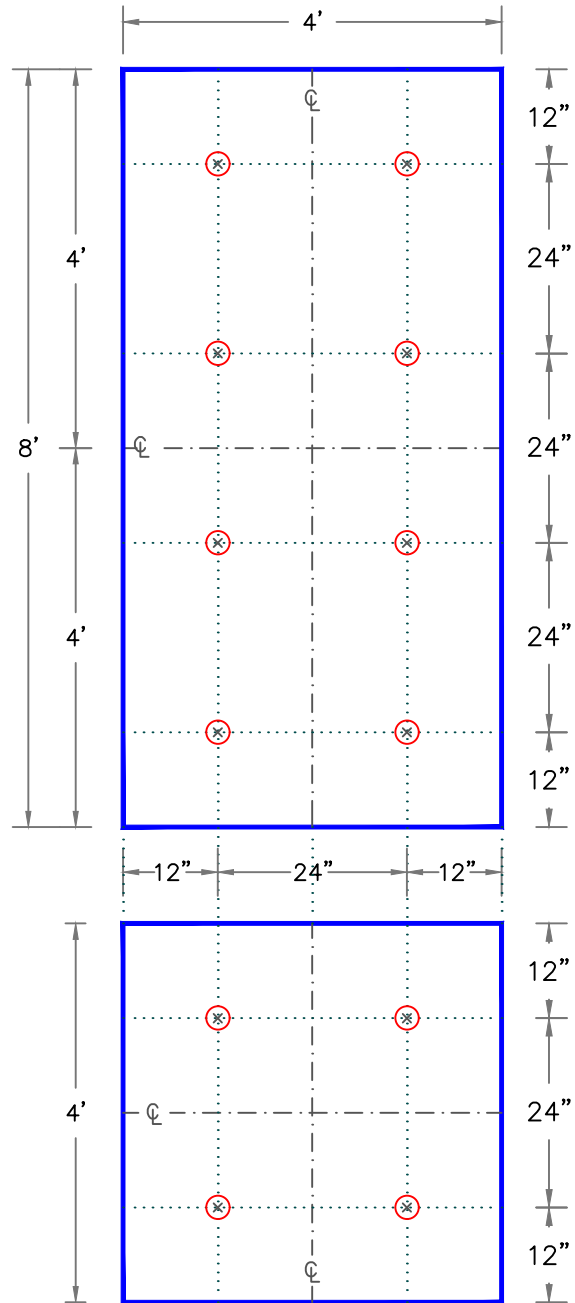
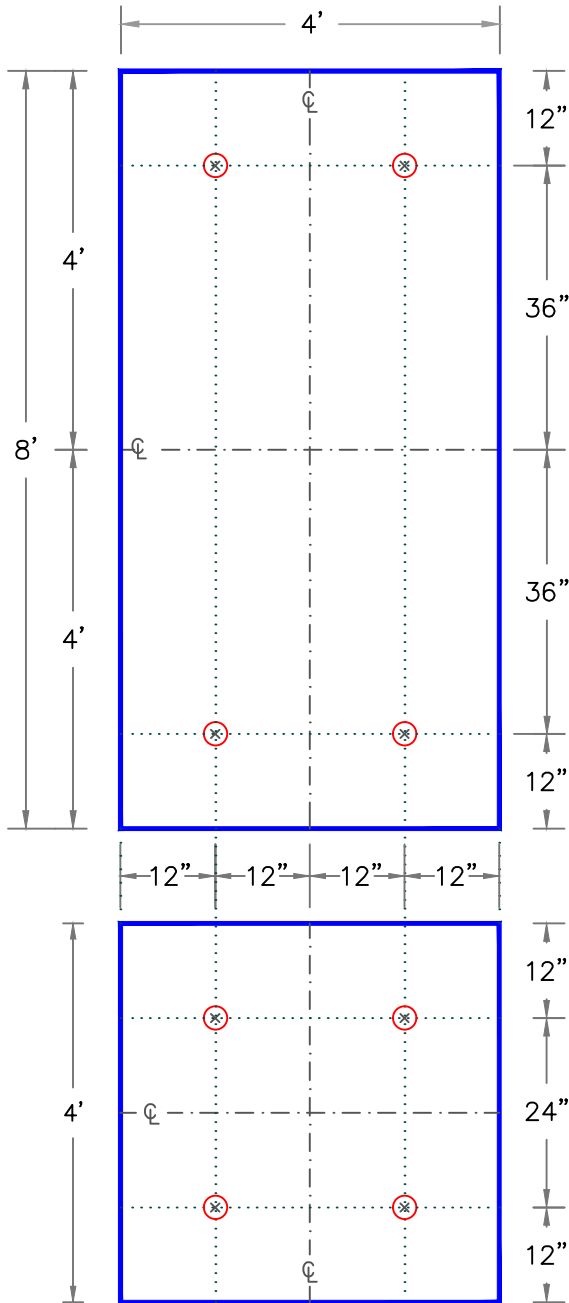

NOTE:

FOR CRITERIA ON INSULATION FASTENERS AND PLATES, REFER TO WEATHERBOND SPECIFICATIONS.

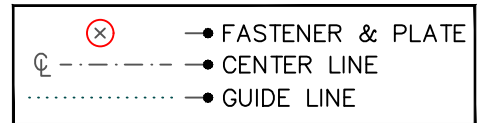

FEET TO MILLIMETERS		INCHES TO MILLIMETERS																				
4'	8'	inch	1/8"	1/4"	5/32"	1/2"	5/8"	3/4"	1"	1.5"	2"	2.5"	3"	4"	6"	8"	9"	11"	12"	18"	24"	36"
1219	2438	mm	3	6	12	13	16	19	25	38	51	63	76	102	152	203	229	279	305	457	610	914

