

# WeatherBond Fleece Membranes

## Mechanically Attached Roofing System

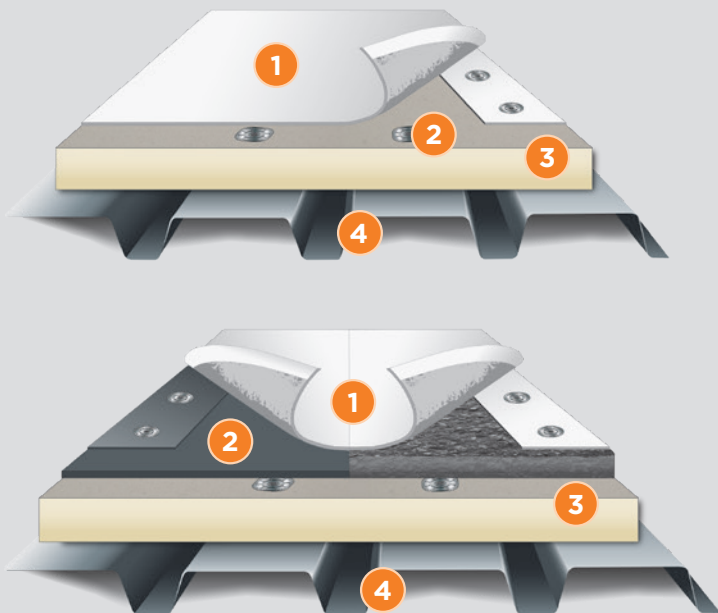

### Typical Application

- 1 Fleece TPO, PVC, or KEE HP membrane
- 2 WeatherBond Plates and Fasteners
- 3 Approved Insulation
- 4 Approved Roof Deck

### Recovery Application

- 1 Fleece TPO, PVC, or KEE HP membrane
- 2 Existing Roof
- 3 Existing Insulation
- 4 Existing Roof Deck

### System Features and Benefits:

- Added Puncture / Tear Resistance
  - Fleece backing provides 30–40% greater puncture resistance and up to 180% greater tear resistance than standard membrane
- Increased Hail Performance
- Expedient installation without interruptions
- Labor-savings 10'- and 12'-wide sheets result in 67–72% fewer seams than a modified bitumen system of comparable size
- Recovery applications reduce noise and disruptions by eliminating tear-offs.

### Fleece Membranes for mechanically fastened roofing systems are available in the following:

Membrane	Thicknesses	Color
TPO	100-mil	White, Gray, and Tan
	115-mil	White, Gray, Tan, and Special Colors*
	135-mil	White, Gray, and Tan
PVC	115-mil	White, Gray, Tan, Light Gray, and Slate Gray
	135-mil	White, Gray, Tan, Light Gray, and Slate Gray
KEE HP	105-mil	White, Gray, and Tan
	115-mil	White, Gray, and Tan
	135-mil	White, Gray, Tan, and Light Gray

\*Five special colors are available: medium bronze, patina green, rock brown, terra cotta, and slate gray



Single-Ply Simplified

	New Construction						Re-roofing		
Existing or New Deck Type	Steel	Plywood or OSB	Lt. Wt. Insulating Concrete	Structural Concrete	Wood Planks	Gypsum & Fibrous Cement	Smooth-Surface BUR	Gravel-Surfaced BUR	Existing Single-Ply
Deck Overlayment Required	Insulation	No	No	No	Insulation	Insulation	No	Insulation	No*
Recommended Insulations	WeatherBond Polyiso, WeatherBond HP Recovery Board or WeatherBond Polyiso over WeatherBond Polystyrene								
Insulation Attached By	WeatherBond Fasteners and Plates								
Membrane Attached By	HPWX Fasteners/HPWX Plates; HPW-XL Fasteners/HPW-XL Plates	HPWX Fasteners/HPWX Plates; HPW-XL Fasteners/HPW-XL Plates	Lt. Wt. Deck Fasteners/Plates	CD-10 or MP 14-10 Fasteners/Plates	HPW Fasteners/HPWX Plates	Lt. Wt. Deck Fasteners/Plates	← Refer to New Construction		

FOR TEAR-OFF OPTIONS REFER TO NEW CONSTRUCTION ABOVE.



**WEATHERBOND**  
ROOFING SYSTEMS

Single-Ply Simplified

P.O. Box 251 | Plainfield, PA 17081 | 866.471.5125 | FAX: 717.960.4034 | [www.weatherbondroofing.com](http://www.weatherbondroofing.com)

© 2021 WeatherBond. 03.24.21 WB-13309 - "WeatherBond Fleece Mechanically Attached System Sheet"  
WeatherBond is a trademark of WeatherBond.