

# WeatherBond **PVC**

## Fully Adhered Roofing System

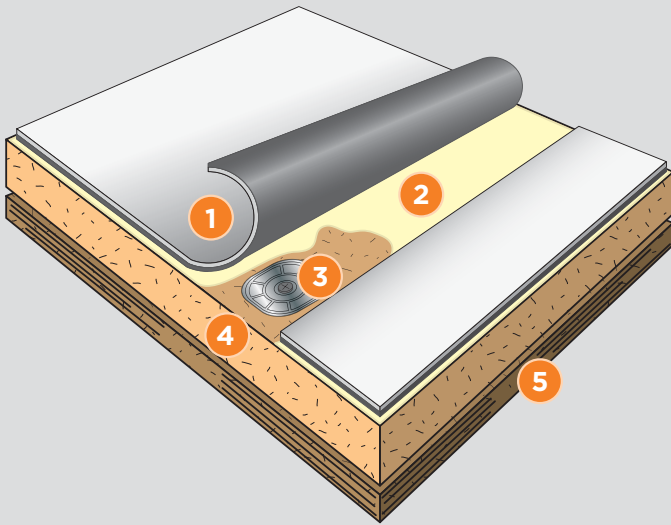

### Typical Application

- 1 WeatherBond PVC 50-, 60-, 80-mil Reinforced Membrane
- 2 Bonding Adhesive
- 3 Fasteners and Plates
- 4 Acceptable Insulation
- 5 Approved Roof Deck

Colors:	White, Gray, Tan
Standard Thicknesses:	50-, 60- and 80-mil
Standard Widths:	40.5", 60", 81" or 120"
Standard Lengths:	50-mil: 100', 60-mil: 100', 80-mil: 85'

### System Features And Benefits:

- Meets ENERGY STAR<sup>®</sup>\*, CRRC, LEED<sup>®</sup> and Title 24 guidelines
- Heat-weldable membranes
- UL/FM codes and approvals
- Highly solar reflective "cool" membrane
- Enhanced physical property characteristics for long-term weatherability
- Excellent chemical resistance to acids, bases, restaurant oils, and greases

### Installation

The WeatherBond PVC Fully Adhered Roofing System utilizes reinforced 50-, 60- or 80-mil thick membranes. Insulation, where required, is secured to an acceptable roof deck.

WeatherBond PVC membrane sheets are fully adhered to the insulation or substrate with either WeatherBond's PVC (Low-VOC) Bonding Adhesive or HydroBond Water Based Adhesive. Adjoining sheets are hot-air welded.

The above information represents a typical WeatherBond PVC Fully Adhered Roofing System. Refer to WeatherBond's published installation instructions for more complete information.

### Certified Fabricated Accessories

Certified Fabricated Accessories (CFAs) are the only factory-fabricated PVC accessories that meet the stringent quality tolerances required to be included in a warranted WeatherBond PVC roofing system.



**WEATHERBOND**  
ROOFING SYSTEMS

Single-Ply Simplified

## Membrane and System Strengths

- WeatherBond PVC membranes come in 120", 81", 60" and 40½"-wide sheets in 50-, 60-, and 80-mil thicknesses
- Available in white, gray, and tan
- Incorporates a strong polyester reinforcement giving the membrane excellent tear, breaking and puncture resistance
- Available with fiberglass reinforcement for additional dimensional stability
- Excellent chemical resistance to acids, bases, restaurant oils and greases
- Fiberglass reinforcement available for fully adhered applications only.
- Wide window of weldability affords easy membrane seaming
- Hot-air-welded seams enhance ease of installation
- High solar reflectivity

## Typical Properties and Characteristics

	Test Method	White PVC	Gray PVC	Tan PVC
ENERGY STAR® initial solar reflectance	Solar Spectrum Reflectometer	0.87	N/A	N/A
ENERGY STAR solar reflectance after 3 years	Solar Spectrum Reflectometer (uncleaned)	0.61	N/A	N/A
CRRC initial solar reflectance	ASTM C1549	0.87	0.59	0.73
CRRC solar reflectance after 3 years	ASTM C1549 (uncleaned)	0.61	N/A	N/A
CRRC initial thermal emittance	ASTM C1371	0.95	0.85	0.86
CRRC thermal emittance after 3 years	ASTM C1371 (uncleaned)	0.86	N/A	N/A
LEED® thermal emittance	ASTM E408	0.94	N/A	N/A
SRI (Solar Reflectance Index)	ASTM E1980	111	69	89

Typical properties and characteristics are based on samples tested and are not guaranteed for all samples of this product. This data and information is intended as a guide and does not reflect the specification range for any particular property of this product.



### New Construction

### Re-roofing

Existing or New Deck Type	New Construction						Re-roofing		
	Steel	Plywood or OSB	Lt. Wt. Concrete	Structural Concrete	Wood Planks	Gypsum & Fibrous Cement	Smooth-Surface BUR	Gravel-Surfaced BUR	Existing Single-Ply
Insulation Required	Yes	No	Yes	No	Yes	Yes	No	Yes	Yes
Recommended Insulation	Polyiso, ODB, Recovery Board, Densdeck® Prime or approved insulation over WeatherBond polystyrene						← Refer to New Construction		
Insulation Attached By	Urethane foam adhesive, insulation or HPW fasteners						← Refer to Specifications		
Membrane Attached By	PVC Bonding Adhesive or Hydrobond Water Based Adhesive						← Refer to New Construction		

FOR TEAR-OFF OPTIONS REFER TO NEW CONSTRUCTION ABOVE.

For current code approvals visit WeatherBond's web site, or contact a WeatherBond Design Analyst.



**WEATHERBOND**  
ROOFING SYSTEMS

Single-Ply Simplified

P.O. Box 251 | Plainfield, PA 17081 | 866.471.5125 | FAX: 717.960.4034 | [www.weatherbondroofing.com](http://www.weatherbondroofing.com)

© 2018 WeatherBond. 06.29.18 REPRINT REQUEST CODE: 609327 - "WeatherBond PVC Fully Adhered System Sheet"  
WeatherBond is a trademark of WeatherBond. DensDeck and DensDeck Prime are trademarks of Georgia Pacific.  
ENERGY STAR qualification is only valid in the U.S. ENERGY STAR is a registered trademark of the U.S. Government.  
LEED is a registered trademark of the U.S. Green Building Council.