

# WeatherBond EPDM

## Mechanically Attached Metal Retrofit Roofing System

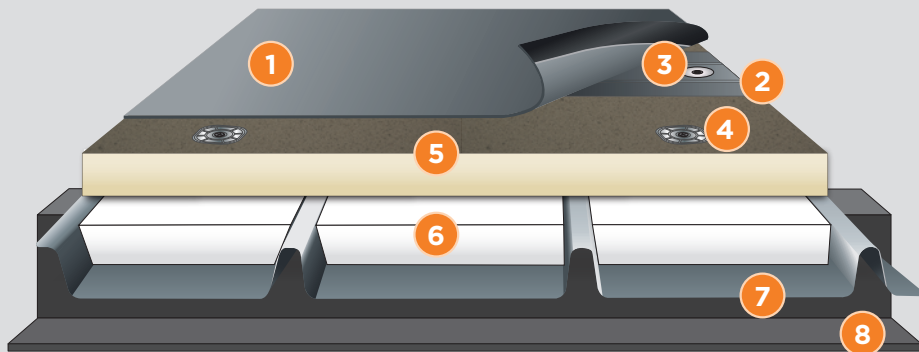

### Typical Application

- 1 Reinforced Black EPDM Membrane
- 2 9"-Wide Peel & Stick Reinforced Perimeter Strip (P&S RPS)
- 3 Purlin Fasteners and Polymer Seam Plates
- 4 Insulation Fasteners and Plates
- 5 Acceptable Insulation
- 6 Flute Fill Insulation
- 7 Existing Metal Roof
- 8 Structural Purlin

<b>Colors:</b>	Black (EPDM)
<b>Standard Thicknesses:</b>	45-, 60- and 75-mil
<b>Standard Widths:</b>	6.5' or 10' (reinforced EPDM)
<b>Standard Lengths:</b>	100'

### System Features And Benefits:

- Retrofit option provides a long-term solution to metal roof problems
- Membrane attached to structural steel purlin
- Retrofit systems reduce noise associated with metal roofs
- Retrofit systems permit the addition of insulation to improve the energy efficiency of the structure
- UL Class A, B and universal slope ratings are available

### WeatherBond Reinforced EPDM Membrane

WeatherBond polyester-reinforced EPDM roof membranes are available in thicknesses of 45-mil (1.14 mm), 60-mil (1.52 mm), and 75-mil (1.9 mm). Standard sheet size is 10' x 100' (3 m x 30 m). WeatherBond offers 6.5' (1.98 m) wide sheets, ideal for use as perimeter sheets and to achieve certain uplift ratings, in 45- and 60-mil thicknesses. WeatherBond membranes are formulated with fire retardants to inhibit spread of flame and meet or exceed UL Class A requirements for slopes up to 3" (76.2 mm), depending on the assembly.

### WeatherBond EPDM with Pre-Applied Seam Tape

With WeatherBond's Factory-Applied Seam Tape, most of the labor to create seams between membrane panels is completed in a quality-controlled, state-of-the-art environment. This process results in a reliable seam with greater peel and shear strengths and with no entrapped air bubbles. Consistent placement of the seam tape also maximizes the splice area and results in a high-quality seam.



**WEATHERBOND**  
ROOFING SYSTEMS

Single-Ply Simplified

## **Metal Retrofit Mechanically Attached**

WeatherBond's 9"-wide P&S RPS strip with two 3" strips of Peel & Stick Seam Tape on either side is fastened into the structural purlins using Purlin Fasteners and Polymer Seam Plates for proper wind uplift resistance. Membrane securement is achieved by attaching WeatherBond EPDM membrane to the RPS strips that are fastened into the structural purlins. Adjoining membrane sheets are spliced together using WeatherBond P&S Seam Tape.

## **Insulation**

### **Flute-Fill Insulation**

A key component of a metal retrofit system is the addition of custom-fit insulation between the standing seams of the metal roof panels. WeatherBond offers both EPS (expanded polystyrene) and Polyiso flute-fill insulation that can be factory cut to fit between each metal panel. This insulation layer also adds R-value and can be loose-laid or adhered.

### **Additional Insulation**

Once flute-fill insulation has been installed, additional insulation ranging from a ¼-inch cover board to several inches of polyiso insulation can be mechanically fastened to the metal roof to create a smooth flat substrate for the membrane. Adding polyiso insulation and cover boards can add additional R-value to the system. Using a high-compressive strength polyiso cover board or gypsum cover board can also enhance impact resistance and fire resistance

REVIEW CURRENT WEATHERBOND INSTALLATION INSTRUCTIONS FOR SPECIFIC INSTALLATION REQUIREMENTS.



**WEATHERBOND**  
ROOFING SYSTEMS

**Single-Ply Simplified**

P.O. Box 251 | Plainfield, PA 17081 | 866.471.5125 | FAX: 717.960.4034 | [www.weatherbondroofing.com](http://www.weatherbondroofing.com)

© 2020 WeatherBond. 12.22.20 WB-7732 - "WeatherBond Mechanically Attached Metal Retrofit System Sheet"  
WeatherBond is a trademark of WeatherBond.